

Size Dia 0.1 - 6.0 mm

Flutes 2



C-UMD



Micro drills

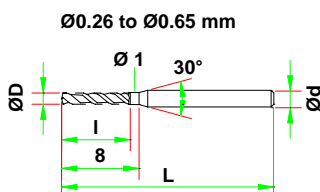
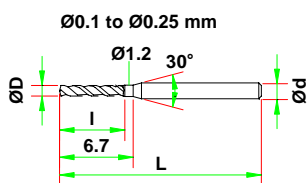

Super Micro Grain Carbide

UT MICRO Coating

Diameter Tolerance $D < 3 \text{ mm} : D +0 / -0.01$

$D > 3 \text{ mm} : D +0 / -0.014$

Point Angle 150°

Shank Tolerance $+0 / -0.005 \text{ mm}$

Ø0.66 to Ø6.0 mm

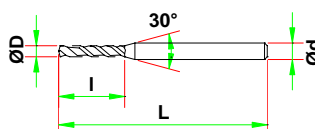

units = mm

Union Tool Part Number	Diameter	Flute Length	Shank Dia	Overall length	Price Estl	Price Euro
	D	I	d	L		
C-UMD 2010-012	0.10	1.2	3	38		
C-UMD 2011-012	0.11	1.2	3	38		
C-UMD 2012-014	0.12	1.4	3	38		
C-UMD 2013-014	0.13	1.4	3	38		
C-UMD 2014-014	0.14	1.4	3	38		
C-UMD 2015-020	0.15	2.0	3	38		
C-UMD 2016-020	0.16	2.0	3	38		
C-UMD 2017-020	0.17	2.0	3	38		
C-UMD 2018-020	0.18	2.0	3	38		
C-UMD 2019-020	0.19	2.0	3	38		
C-UMD 2020-025	0.20	2.5	3	38		
C-UMD 2021-025	0.21	2.5	3	38		
C-UMD 2022-025	0.22	2.5	3	38		
C-UMD 2023-025	0.23	2.5	3	38		
C-UMD 2024-025	0.24	2.5	3	38		
C-UMD 2025-030	0.25	3.0	3	38		
C-UMD 2026-030	0.26	3.0	3	38		
C-UMD 2027-030	0.27	3.0	3	38		
C-UMD 2028-030	0.28	3.0	3	38		
C-UMD 2029-030	0.29	3.0	3	38		
C-UMD 2030-050	0.30	5.0	3	38		
C-UMD 2031-050	0.31	5.0	3	38		
C-UMD 2032-050	0.32	5.0	3	38		
C-UMD 2033-050	0.33	5.0	3	38		
C-UMD 2034-050	0.34	5.0	3	38		
C-UMD 2035-060	0.35	6.0	3	38		
C-UMD 2036-060	0.36	6.0	3	38		
C-UMD 2037-060	0.37	6.0	3	38		
C-UMD 2038-060	0.38	6.0	3	38		
C-UMD 2039-060	0.39	6.0	3	38		
C-UMD 2040-070	0.40	7.0	3	38		
C-UMD 2041-070	0.41	7.0	3	38		
C-UMD 2042-070	0.42	7.0	3	38		
C-UMD 2043-070	0.43	7.0	3	38		
C-UMD 2044-070	0.44	7.0	3	38		
C-UMD 2045-070	0.45	7.0	3	38		
C-UMD 2046-070	0.46	7.0	3	38		
C-UMD 2047-070	0.47	7.0	3	38		
C-UMD 2048-070	0.48	7.0	3	38		

Union Tool Part Number	Diameter	Flute Length	Shank Dia	Overall length	Price £stl	Price Euro
	D	I	d	L		
C-UMD 2049-070	0.49	7.0	3	38		

Union Tool Part Number	Diameter	Flute Length	Shank Dia	Overall length	Price Estl	Price Euro
	D	I	d	L		
C-UMD 2050-070	0.50	7.0	3	38		
C-UMD 2051-070	0.51	7.0	3	38		
C-UMD 2052-070	0.52	7.0	3	38		
C-UMD 2053-070	0.53	7.0	3	38		
C-UMD 2054-070	0.54	7.0	3	38		
C-UMD 2055-070	0.55	7.0	3	38		
C-UMD 2056-070	0.56	7.0	3	38		
C-UMD 2057-070	0.57	7.0	3	38		
C-UMD 2058-070	0.58	7.0	3	38		
C-UMD 2059-070	0.59	7.0	3	38		
C-UMD 2060-070	0.60	7.0	3	38		
C-UMD 2061-070	0.61	7.0	3	38		
C-UMD 2062-070	0.62	7.0	3	38		
C-UMD 2063-070	0.63	7.0	3	38		
C-UMD 2064-070	0.64	7.0	3	38		
C-UMD 2065-070	0.65	7.0	3	38		
C-UMD 2066-070	0.66	7.0	3	38		
C-UMD 2067-070	0.67	7.0	3	38		
C-UMD 2068-070	0.68	7.0	3	38		
C-UMD 2069-070	0.69	7.0	3	38		
C-UMD 2070-080	0.70	8.0	3	38		
C-UMD 2071-080	0.71	8.0	3	38		
C-UMD 2072-080	0.72	8.0	3	38		
C-UMD 2073-080	0.73	8.0	3	38		
C-UMD 2074-080	0.74	8.0	3	38		
C-UMD 2075-080	0.75	8.0	3	38		
C-UMD 2076-080	0.76	8.0	3	38		
C-UMD 2077-080	0.77	8.0	3	38		
C-UMD 2078-080	0.78	8.0	3	38		
C-UMD 2079-080	0.79	8.0	3	38		
C-UMD 2080-100	0.80	10.0	3	38		
C-UMD 2081-100	0.81	10.0	3	38		
C-UMD 2082-100	0.82	10.0	3	38		
C-UMD 2083-100	0.83	10.0	3	38		
C-UMD 2084-100	0.84	10.0	3	38		
C-UMD 2085-100	0.85	10.0	3	38		
C-UMD 2086-100	0.86	10.0	3	38		
C-UMD 2087-100	0.87	10.0	3	38		
C-UMD 2088-100	0.88	10.0	3	38		
C-UMD 2089-100	0.89	10.0	3	38		
C-UMD 2090-100	0.90	10.0	3	38		
C-UMD 2091-100	0.91	10.0	3	38		
C-UMD 2092-100	0.92	10.0	3	38		
C-UMD 2093-100	0.93	10.0	3	38		
C-UMD 2094-100	0.94	10.0	3	38		
C-UMD 2095-100	0.95	10.0	3	38		
C-UMD 2096-100	0.96	10.0	3	38		
C-UMD 2097-100	0.97	10.0	3	38		
C-UMD 2098-100	0.98	10.0	3	38		
C-UMD 2099-100	0.99	10.0	3	38		
C-UMD 2100-100	1.00	10.0	3	38		
C-UMD 2101-100	1.01	10.0	3	38		
C-UMD 2102-100	1.02	10.0	3	38		
C-UMD 2103-100	1.03	10.0	3	38		
C-UMD 2104-100	1.04	10.0	3	38		
C-UMD 2105-100	1.05	10.0	3	38		
C-UMD 2106-100	1.06	10.0	3	38		
C-UMD 2107-100	1.07	10.0	3	38		
C-UMD 2108-100	1.08	10.0	3	38		
C-UMD 2109-100	1.09	10.0	3	38		
C-UMD 2110-100	1.10	10.0	3	38		
C-UMD 2111-100	1.11	10.0	3	38		
C-UMD 2112-100	1.12	10.0	3	38		
C-UMD 2113-100	1.13	10.0	3	38		

Union Tool Part Number	Diameter	Flute Length	Shank Dia	Overall length	Price Estl	Price Euro
	D	I	d	L		
C-UMD 2114-100	1.14	10.0	3	38		
C-UMD 2115-100	1.15	10.0	3	38		
C-UMD 2116-100	1.16	10.0	3	38		
C-UMD 2117-100	1.17	10.0	3	38		
C-UMD 2118-100	1.18	10.0	3	38		
C-UMD 2119-100	1.19	10.0	3	38		
C-UMD 2120-100	1.20	10.0	3	38		
C-UMD 2121-100	1.21	10.0	3	38		
C-UMD 2122-100	1.22	10.0	3	38		
C-UMD 2123-100	1.23	10.0	3	38		
C-UMD 2124-100	1.24	10.0	3	38		
C-UMD 2125-100	1.25	10.0	3	38		
C-UMD 2126-100	1.26	10.0	3	38		
C-UMD 2127-100	1.27	10.0	3	38		
C-UMD 2128-100	1.28	10.0	3	38		
C-UMD 2129-100	1.29	10.0	3	38		
C-UMD 2130-100	1.30	10.0	3	38		
C-UMD 2131-100	1.31	10.0	3	38		
C-UMD 2132-100	1.32	10.0	3	38		
C-UMD 2133-100	1.33	10.0	3	38		
C-UMD 2134-100	1.34	10.0	3	38		
C-UMD 2135-100	1.35	10.0	3	38		
C-UMD 2136-100	1.36	10.0	3	38		
C-UMD 2137-100	1.37	10.0	3	38		
C-UMD 2138-100	1.38	10.0	3	38		
C-UMD 2139-100	1.39	10.0	3	38		
C-UMD 2140-100	1.40	10.0	3	38		
C-UMD 2141-100	1.41	10.0	3	38		
C-UMD 2142-100	1.42	10.0	3	38		
C-UMD 2143-100	1.43	10.0	3	38		
C-UMD 2144-100	1.44	10.0	3	38		
C-UMD 2145-100	1.45	10.0	3	38		
C-UMD 2146-100	1.46	10.0	3	38		
C-UMD 2147-100	1.47	10.0	3	38		
C-UMD 2148-100	1.48	10.0	3	38		
C-UMD 2149-100	1.49	10.0	3	38		
C-UMD 2150-100	1.50	10.0	3	38		
C-UMD 2151-100	1.51	10.0	3	38		
C-UMD 2152-100	1.52	10.0	3	38		
C-UMD 2153-100	1.53	10.0	3	38		
C-UMD 2154-100	1.54	10.0	3	38		
C-UMD 2155-100	1.55	10.0	3	38		
C-UMD 2156-100	1.56	10.0	3	38		
C-UMD 2157-100	1.57	10.0	3	38		
C-UMD 2158-100	1.58	10.0	3	38		
C-UMD 2159-100	1.59	10.0	3	38		
C-UMD 2160-120	1.60	12.0	3	38		
C-UMD 2161-120	1.61	12.0	3	38		
C-UMD 2162-120	1.62	12.0	3	38		
C-UMD 2163-120	1.63	12.0	3	38		
C-UMD 2164-120	1.64	12.0	3	38		
C-UMD 2165-120	1.65	12.0	3	38		
C-UMD 2166-120	1.66	12.0	3	38		
C-UMD 2167-120	1.67	12.0	3	38		
C-UMD 2168-120	1.68	12.0	3	38		
C-UMD 2169-120	1.69	12.0	3	38		
C-UMD 2170-120	1.70	12.0	3	38		
C-UMD 2171-120	1.71	12.0	3	38		
C-UMD 2172-120	1.72	12.0	3	38		
C-UMD 2173-120	1.73	12.0	3	38		
C-UMD 2174-120	1.74	12.0	3	38		
C-UMD 2175-120	1.75	12.0	3	38		
C-UMD 2176-120	1.76	12.0	3	38		
C-UMD 2177-120	1.77	12.0	3	38		

Union Tool Part Number	Diameter	Flute Length	Shank Dia	Overall length	Price Estl	Price Euro
	D	I	d	L		
C-UMD 2178-120	1.78	12.0	3	38		
C-UMD 2179-120	1.79	12.0	3	38		
C-UMD 2180-120	1.80	12.0	3	38		
C-UMD 2181-120	1.81	12.0	3	38		
C-UMD 2182-120	1.82	12.0	3	38		
C-UMD 2183-120	1.83	12.0	3	38		
C-UMD 2184-120	1.84	12.0	3	38		
C-UMD 2185-120	1.85	12.0	3	38		
C-UMD 2186-120	1.86	12.0	3	38		
C-UMD 2187-120	1.87	12.0	3	38		
C-UMD 2188-120	1.88	12.0	3	38		
C-UMD 2189-120	1.89	12.0	3	38		
C-UMD 2190-120	1.90	12.0	3	38		
C-UMD 2191-120	1.91	12.0	3	38		
C-UMD 2192-120	1.92	12.0	3	38		
C-UMD 2193-120	1.93	12.0	3	38		
C-UMD 2194-120	1.94	12.0	3	38		
C-UMD 2195-120	1.95	12.0	3	38		
C-UMD 2196-120	1.96	12.0	3	38		
C-UMD 2197-120	1.97	12.0	3	38		
C-UMD 2198-120	1.98	12.0	3	38		
C-UMD 2199-120	1.99	12.0	3	38		
C-UMD 2200-120	2.00	12.0	3	38		
C-UMD 2205-120	2.05	12.0	3	38		
C-UMD 2210-120	2.10	12.0	3	38		
C-UMD 2215-120	2.15	12.0	3	38		
C-UMD 2220-120	2.20	12.0	3	38		
C-UMD 2225-120	2.25	12.0	3	38		
C-UMD 2230-120	2.30	12.0	3	38		
C-UMD 2235-120	2.35	12.0	3	38		
C-UMD 2240-120	2.40	12.0	3	38		
C-UMD 2245-120	2.45	12.0	3	38		
C-UMD 2250-120	2.50	12.0	3	38		
C-UMD 2255-120	2.55	12.0	3	38		
C-UMD 2260-120	2.60	12.0	3	38		
C-UMD 2265-120	2.65	12.0	3	38		
C-UMD 2270-120	2.70	12.0	3	38		
C-UMD 2275-120	2.75	12.0	3	38		
C-UMD 2280-120	2.80	12.0	3	38		
C-UMD 2285-120	2.85	12.0	3	38		
C-UMD 2290-120	2.90	12.0	3	38		
C-UMD 2295-120	2.95	12.0	3	38		
C-UMD 2300-120	3.00	12.0	3	38		
C-UMD 2305-200	3.05	20.0	4	60		
C-UMD 2310-200	3.10	20.0	4	60		
C-UMD 2315-200	3.15	20.0	4	60		
C-UMD 2320-200	3.20	20.0	4	60		
C-UMD 2325-200	3.25	20.0	4	60		
C-UMD 2330-200	3.30	20.0	4	60		
C-UMD 2335-200	3.35	20.0	4	60		
C-UMD 2340-200	3.40	20.0	4	60		
C-UMD 2345-200	3.45	20.0	4	60		
C-UMD 2350-200	3.50	20.0	4	60		
C-UMD 2355-200	3.55	20.0	4	60		
C-UMD 2360-200	3.60	20.0	4	60		
C-UMD 2365-200	3.65	20.0	4	60		
C-UMD 2370-200	3.70	20.0	4	60		
C-UMD 2375-200	3.75	20.0	4	60		
C-UMD 2380-200	3.80	20.0	4	60		
C-UMD 2385-200	3.85	20.0	4	60		
C-UMD 2390-200	3.90	20.0	4	60		
C-UMD 2395-200	3.95	20.0	4	60		
C-UMD 2400-300	4.00	30.0	6	80		
C-UMD 2405-300	4.05	30.0	6	80		

Union Tool Part Number	Diameter	Flute Length	Shank Dia	Overall length	Price Estl	Price Euro
	D	L	d	L		
C-UMD 2410-300	4.10	30.0	6	80		
C-UMD 2415-300	4.15	30.0	6	80		
C-UMD 2420-300	4.20	30.0	6	80		
C-UMD 2425-300	4.25	30.0	6	80		
C-UMD 2430-300	4.30	30.0	6	80		
C-UMD 2435-300	4.35	30.0	6	80		
C-UMD 2440-300	4.40	30.0	6	80		
C-UMD 2445-300	4.45	30.0	6	80		
C-UMD 2450-300	4.50	30.0	6	80		
C-UMD 2455-300	4.55	30.0	6	80		
C-UMD 2460-300	4.60	30.0	6	80		
C-UMD 2465-300	4.65	30.0	6	80		
C-UMD 2470-300	4.70	30.0	6	80		
C-UMD 2475-300	4.75	30.0	6	80		
C-UMD 2480-300	4.80	30.0	6	80		
C-UMD 2485-300	4.85	30.0	6	80		
C-UMD 2490-300	4.90	30.0	6	80		
C-UMD 2495-300	4.95	30.0	6	80		
C-UMD 2500-400	5.00	40.0	6	100		
C-UMD 2505-400	5.05	40.0	6	100		
C-UMD 2510-400	5.10	40.0	6	100		
C-UMD 2515-400	5.15	40.0	6	100		
C-UMD 2520-400	5.20	40.0	6	100		
C-UMD 2525-400	5.25	40.0	6	100		
C-UMD 2530-400	5.30	40.0	6	100		
C-UMD 2535-400	5.35	40.0	6	100		
C-UMD 2540-400	5.40	40.0	6	100		
C-UMD 2545-400	5.45	40.0	6	100		
C-UMD 2550-400	5.50	40.0	6	100		
C-UMD 2555-400	5.55	40.0	6	100		
C-UMD 2560-400	5.60	40.0	6	100		
C-UMD 2565-400	5.65	40.0	6	100		
C-UMD 2570-400	5.70	40.0	6	100		
C-UMD 2575-400	5.75	40.0	6	100		
C-UMD 2580-400	5.80	40.0	6	100		
C-UMD 2585-400	5.85	40.0	6	100		
C-UMD 2590-400	5.90	40.0	6	100		
C-UMD 2595-400	5.95	40.0	6	100		
C-UMD 2600-400	6.00	40.0	6	100		