

Size Dia 0.2 - 1.0 mm

Flutes 2

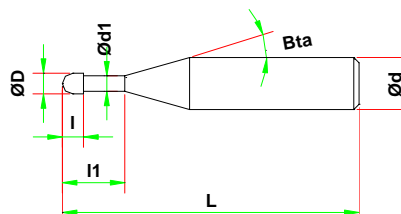

CBN-LB



Applicable Work Materials

(MS = Most Suitable S = Suitable)

Work Materials										
Carbon steels	Alloy Steels	Prehardened steels	Hardened steels			Cast Iron	Aluminium Alloy	Graphite	Copper	Plastic
			55HRC	60HRC	65HRC					
	S	S	MS	MS	MS					

units = mm

Union Tool Part Number	Diameter	Effective Length	Flute Length	Neck Diameter	Shank Taper Angle	Overall Length	Shank Dia	Price £stl	Price Euro
	D	l₁	l	d₁	Bta	L	d		
CBN-LB 2002-004	0.2	0.4	0.16	0.17	0.16	45	4		
CBN-LB 2002-008		0.8							
CBN-LB 2002-012		1.2							
CBN-LB 2003-006	0.3	0.6	0.24	0.27	0.24	45	4		
CBN-LB 2003-012		1.2							
CBN-LB 2003-018		1.8							
CBN-LB 2004-008	0.4	0.8	0.32	0.37	0.32	45	4		
CBN-LB 2004-016		1.6							
CBN-LB 2004-024		2.4							
CBN-LB 2005-010	0.5	1	0.4	0.47	0.4	45	4		
CBN-LB 2005-020		2							
CBN-LB 2006-012	0.6	1.2	0.48	0.57	0.48	45	4		
CBN-LB 2006-024		2.4							
CBN-LB 2008-016	0.8	1.6	0.64	0.77	0.64	45	4		
CBN-LB 2010-020	1	2	0.8	0.96	0.8	45	4		